

TOGGLE

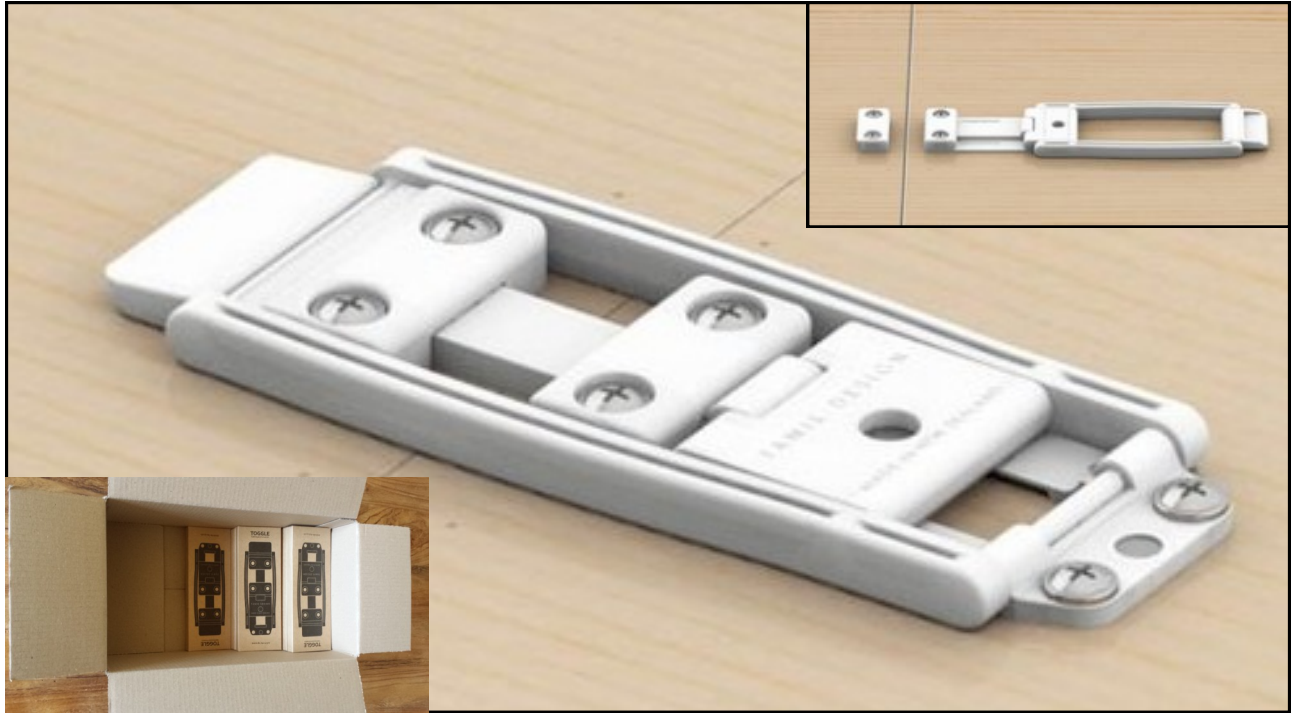

Article No. 642.43.727

Toggle is a robust easy-to-use fold-away table and panel connector that provides alignment and a positive connection. *Toggle* folds out of the way when not in use, and is magnetically stored in a low-profile unobtrusive position.

Toggle clamps and aligns surfaces both horizontally and vertically.

The card packaging is also the drilling template.

Product details

Material: Acetyl/Nylon

Color: Black

Finish: Natural

Capacity: Max clamping force up to 50 kg tested on plywood

Pull capacity 80kg - Tested on plywood.

Dimensions: 193 x 70 x 11mm

Supplied with screws

Bulk packaging details

Packaging quantity: 50

Volume of carton: 0.001 m3

Dimensions of carton: 360 x 200 x 135mm

Weight of pack: 6.5 kg

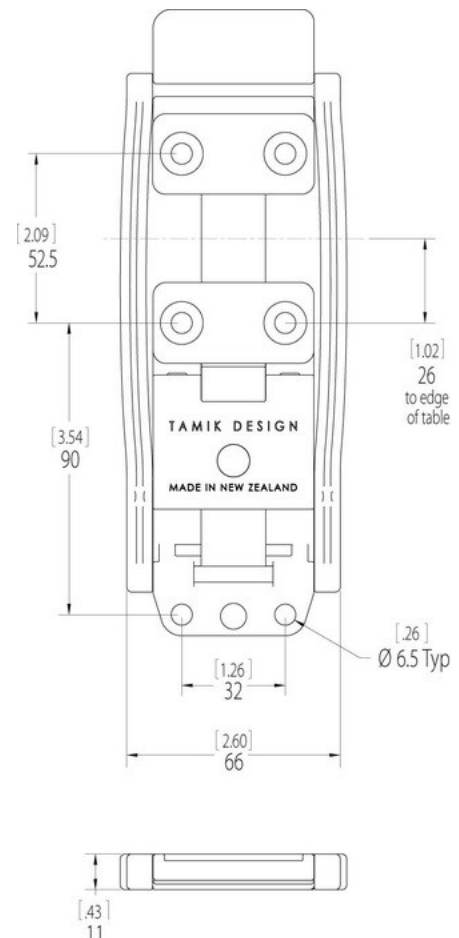

DIMENSIONS IN MILLIMETRES [INCHES]

NOT TO SCALE

TAMIK DESIGN Ltd

HANG-IT

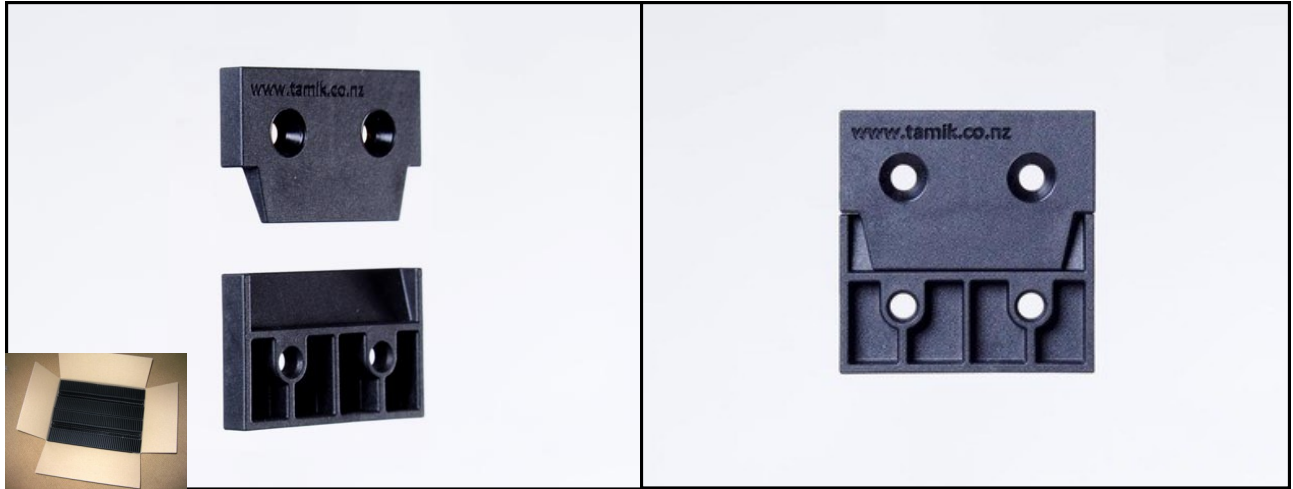

Article No. 290.06.310 (2 assemblies)

Hang just about anything on the wall securely, elegantly and with minimum fuss. No visible fixings. Manufactured from engineering plastic, so virtually unbreakable. *Hang-it* can be used for hanging kitchen cupboards, speakers, acoustic panels, and notice boards.

Product details

Material: Glass filled Nylon

Color: Black

Finish: Natural

Capacity: Each clip will hold 70kg Vertically (depending on fixings and substrate of wall)

Bulk packaging details

Packaging quantity: 200 sets

Volume of carton: 0.00819 m³

Dimensions of carton: 350 x 270 x 90 mm

Weight of pack: 3.6 kg

Screws(not included)

Use flat head countersunk 4mm screw dia.

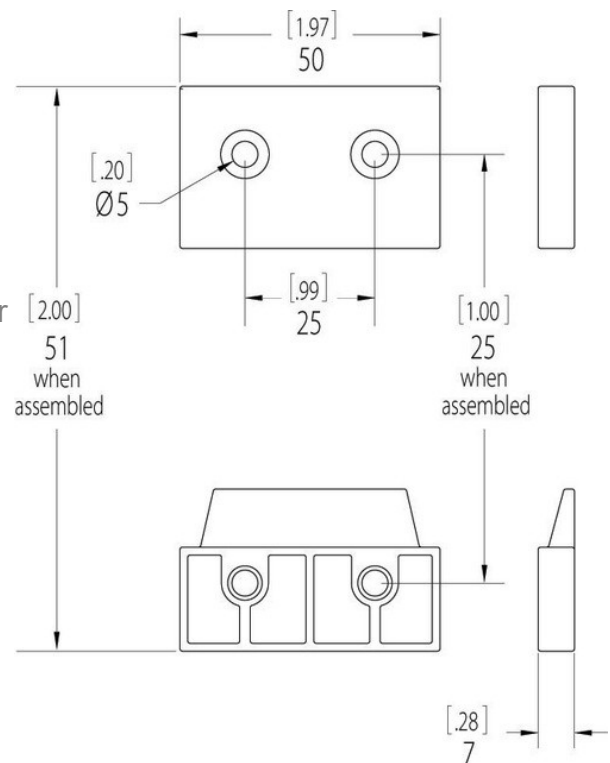

DIMENSIONS IN MILLIMETRES [INCHES]

NOT TO SCALE

DUO HOOK

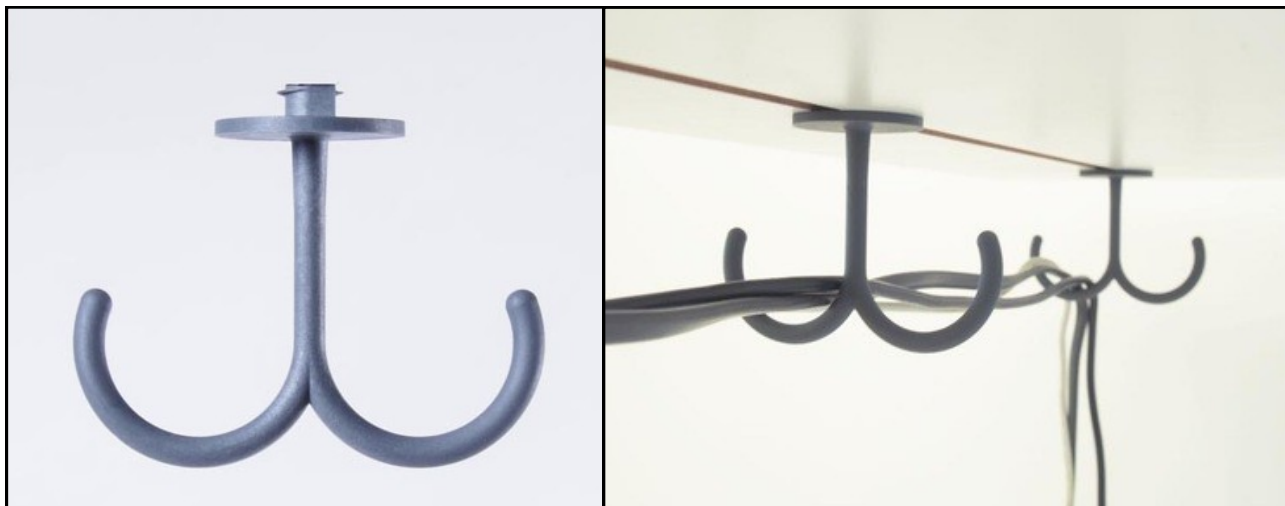

Article No. 631.09.310

This clever little cable- and wire-management hook is easy to install and simple to re-position. Place it anywhere along a machined slot in the underside of a desk or table, and with a quarter turn lock it firmly in place. A quarter turn in the opposite direction unlocks the hook, allowing you to slide it along the slot to a new position. Provides a simple and re-configurable way to keep wires tidy.

Product details

Material: Glass filled Nylon

Color: Grey

Finish: Natural

Dimensions: 75 x 61 x 31mm

Machine groove 8mm wide, 7mm deep

Bulk packaging details

Packaging quantity: 250

Volume of carton: 0.0274 m³

Dimensions of carton: 340 x 260 x 310 mm

Weight of pack: 3.7 kg

Custom's code: 3926.30.00K

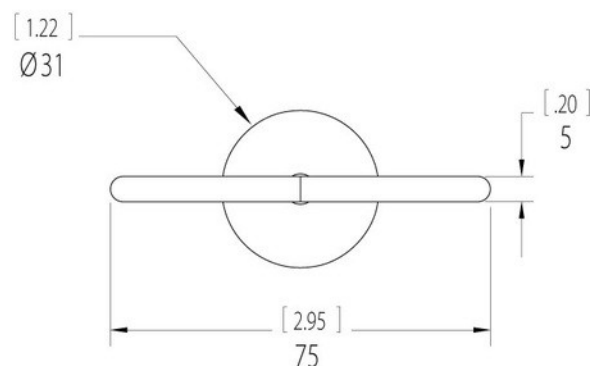
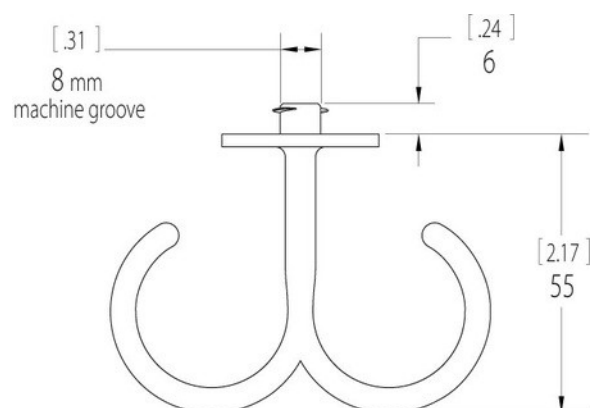

DIMENSIONS IN MILLIMETRES [INCHES]

NOT TO SCALE

LINK-IT



Article No. 642.43.300

Link-it is an elegant, simple, and robust solution to joining tables and panels. A low profile and recessed screw holes means no more snagged trousers or tights.

Other colors on request. Also Available in raw zinc. (Does not include screws)

Product details

Material: Zinc

Color: Anthracite

Finish: Powder coated

Dimensions: 64 x 75 x 9 mm

Bulk packaging details

Packaging quantity: 100

Volume of carton: 0.0123 m³

Dimensions of carton: 430 x 260 x 110 mm

Weight of pack: 11.5kg

Custom's code: 8302.42.00.29b

Screws (not included)

Use Häfele Euro screws

013.10.149 13.5mm or

013.10.190 19mm

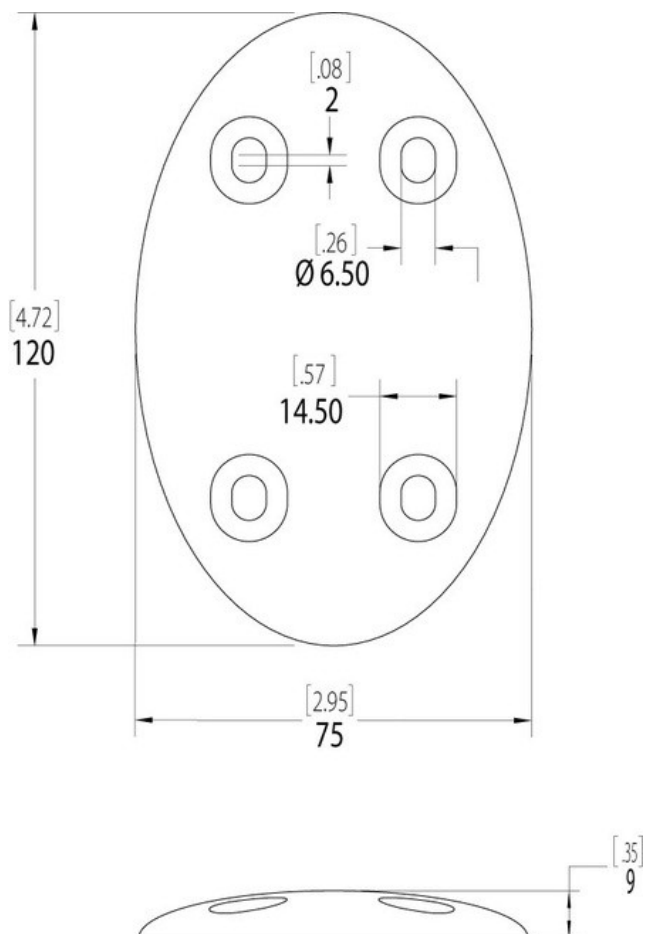

DIMENSIONS IN MILLIMETRES [INCHES]

NOT TO SCALE

CAM-IT



Article No. 642.43.310

Cam-it is a tool-free fold-away modular connector for desks and table tops. Quick and easy to operate. Invisible when tables are separated. Made from high strength glass-filled Nylon.

Product details

Material: Glass filled Nylon

Color: Black

Finish: Natural

Dimensions: 120 x 46 x 8 mm (assembled)

Bulk packaging details

Packaging quantity: 250

Volume of carton: 0.028 m³

Dimensions of carton: 340 x 260 x 420 mm

Weight of pack: 6.53 kg

Custom's code: 3926.30.00K

Screws(not included)

Use Häfele Euro screws

013.10.149 13.5mm or

013.10.190 19mm

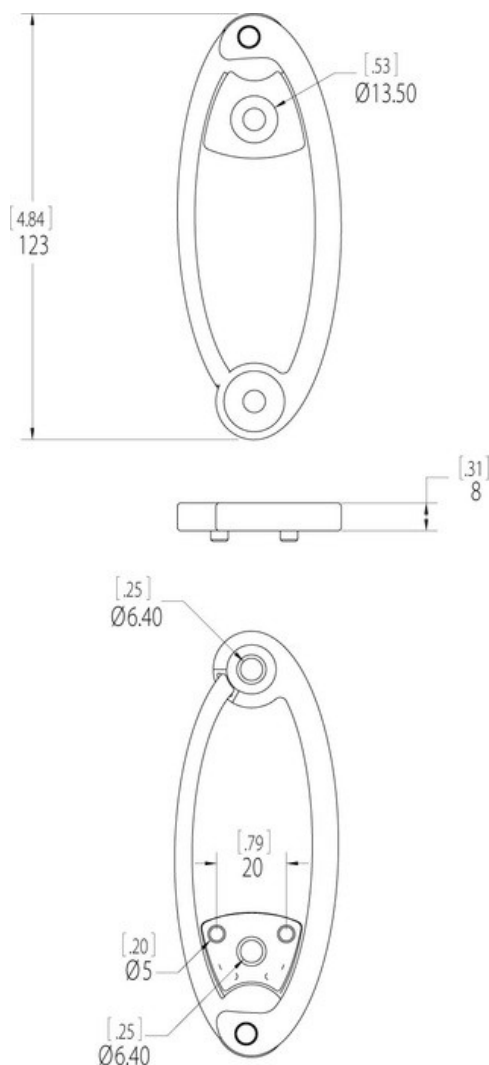

DIMENSIONS IN MILLIMETRES [INCHES]

NOT TO SCALE

TAMIK DESIGN Ltd

TANGO



Article No. 631.10.330 (Satin chrome),
631.10.430 (Anthracite)

A stylish contemporary cable port, *Tango* has a large capacity 80mm hole and a 'champagne cork-type' plug allowing it to swivel in any direction. Two 'snap outs' can be removed for extra-large plugs. Available in satin chrome, anthracite or raw zinc. Special colors on request.

Product details

Material: Zinc & plastic
 Color: Satin chrome (also available in anthracite or raw zinc)
 Finish: Satin chrome plated
 Dimensions: 137 x 90 x 30 mm (boxed)

Bulk packaging details

Packaging quantity: 100 (individually packed)
 Volume of carton: 0.044 m³
 Dimensions of carton: 460 x 290 x 340 mm
 Weight of pack: 14 kg

Custom's code: 8302.42.00.29b

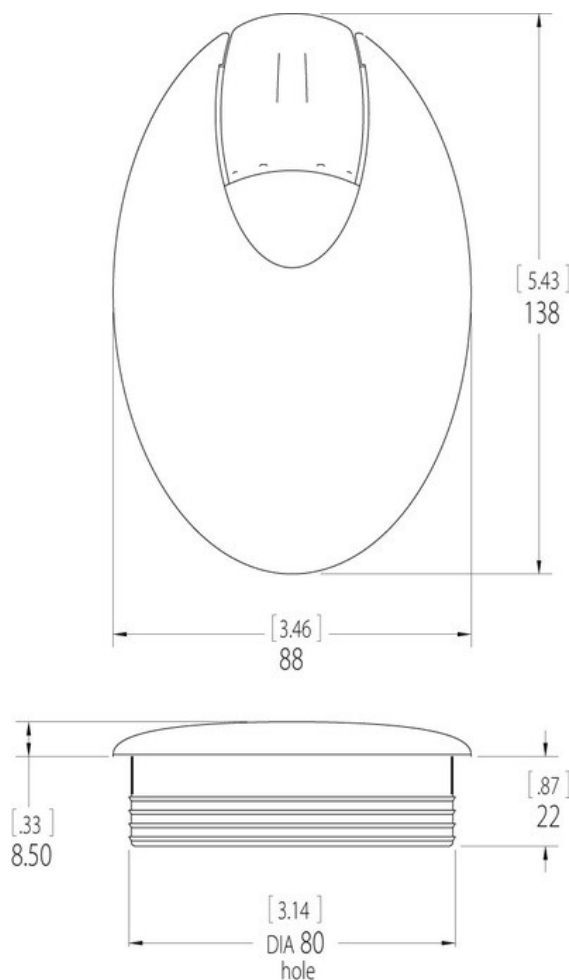

DIMENSIONS IN MILLIMETRES [INCHES]

NOT TO SCALE

TAMIK DESIGN Ltd

WIRE HOOK

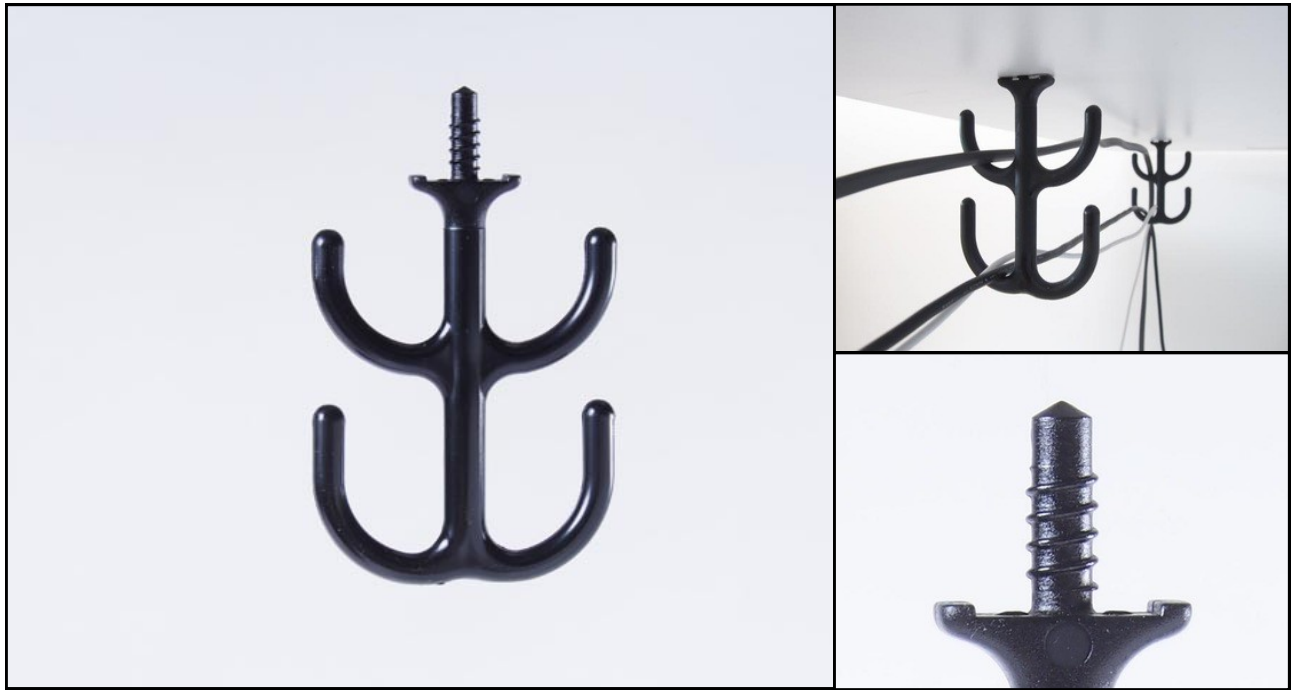

Article No. 631.02.300

Easy to install and user-friendly under-desk wire management. A simple yet functional way to keep wires tidy. The hook has a self-tapping thread for wood and needs a 5mm drilled hole for installation.

Product details

Material: Glass filled Nylon

Color: Black

Finish: Natural

Dimensions: 96 x 57 x 8mm

Bulk packaging details

Packaging quantity: 500

Volume of carton: 0.028 m³

Dimensions of carton: 260 x 340 x 320 mm

Weight of pack: 6 kg

Custom's code: 3926300000K

THE POST



Article No. (see Product details below)

A versatile shelving system for exhibitions, kitchens and the office in durable anodized aluminum. Completely knock down, designed for fast assembly and dis-assembly. No need for tools. Wood to glass, glass to glass, and wood to wood.

Product details

Parts supplied separately:

Zinc Clip

Article No. 505.17.320

Material: Zinc

Finish: Satin chrome plating

Packaging quantity: 200

Volume of pack: 0.01352 m3

Carton 26 x 26 x 21cm

Weight of Pack: 5.2 kg

Custom's code: 8302.42.00.29b

Plastic clip plug

Article No. 505.17.320

Material: Glass filled Nylon

Finish: Natural black

Packaging quantity: 200

Volume of pack: 0.028m3

Carton 26x40x27cm

Weight of Pack: 3.58 kg

Custom's code: 3926300000K

Foot Plug

Article No. 505.17.340

Material: PP

Finish: Natural black

Packaging quantity: 200

Volume of pack: 0.0084 m3

Carton 21x25x16cm

Weight of Pack: 1.12 kg

Custom's code: 3926300000K

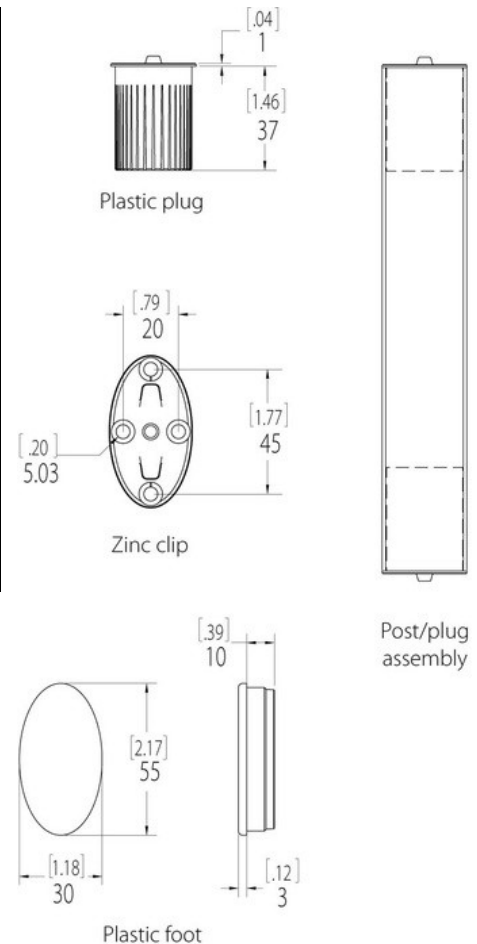

DIMENSIONS IN MILLIMETRES [INCHES]

NOT TO SCALE

Aluminum extrusion

Article No. 505.17.932 (2 meter length)

Material: Aluminum

Finish: Anodized

Packaging quantity: 10 x 2 meter lengths per crate

Volume of pack: 0.04 m3

Cardboard case 2010x290x70 cm

Weight of Pack: 11.5 kg

Custom's code: 8302.42.00.29b

Stainless steel disc

Article No. 505.17.990

Material: Stainless steel

Finish: Brushed

Capacity

Vertical weight capacity is 120kg

WEDGE



Article No. 938.25.000

A solid aluminum door wedge with a rubber base. Can stabilize restaurant tables or become an extra security device. Can be printed with your logo (prices on application).

Product details

Material: Aluminium & rubber

Color: Silver

Finish: Natural glass bead blasted

Dimensions: 72 x 32 x 20 mm

Bulk packaging details

Packaging quantity: 10

Volume of carton: 0,000538 m3

Dimensions of pack: 147 x 87 x 40 mm

Weight of pack: 0.63 kg

Custom's code: 73.23.93.00.90K

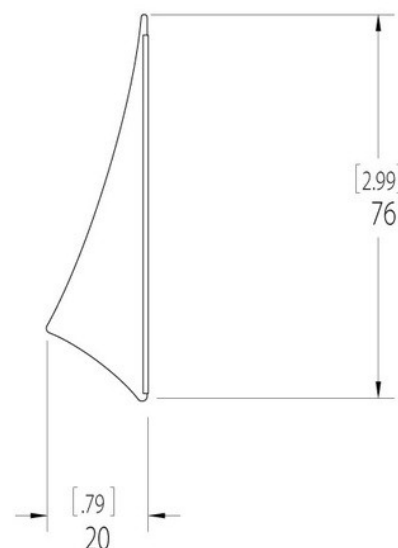
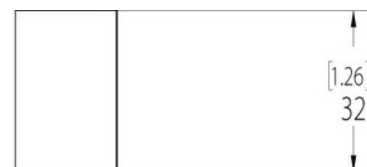

DIMENSIONS IN MILLIMETRES [INCHES]

NOT TO SCALE